

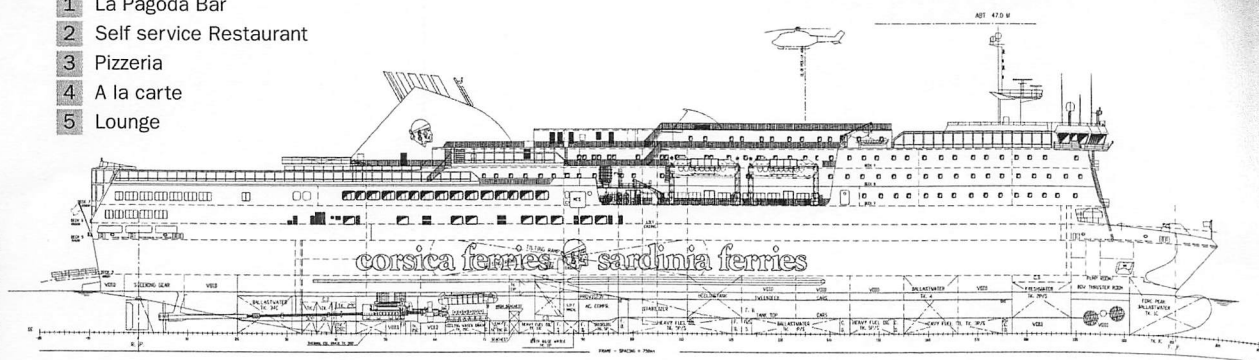

- 1 La Pagoda Bar
- 2 Self service Restaurant
- 3 Pizzeria
- 4 A la carte
- 5 Lounge

MEGA EXPRESS FOUR



- 6 Self service Restaurant
- 7 Cafeteria
- 8 Restaurant
- 9 Air seat lounges

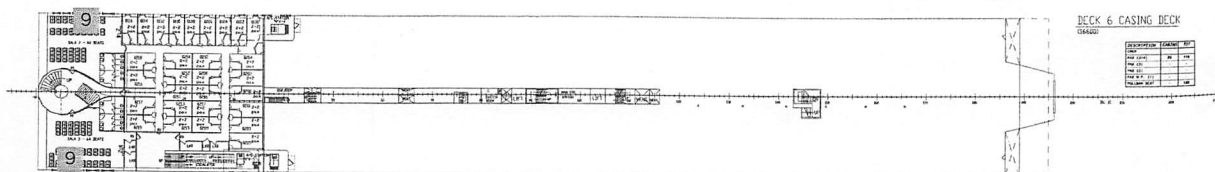
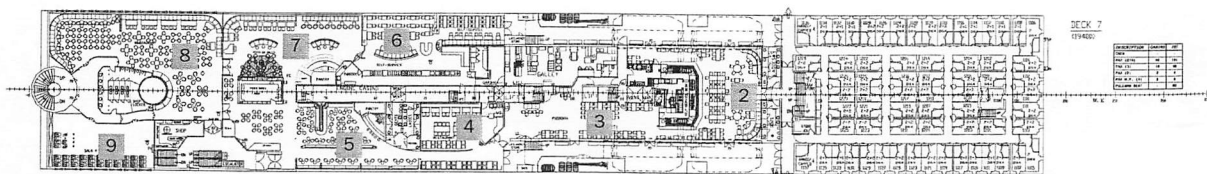
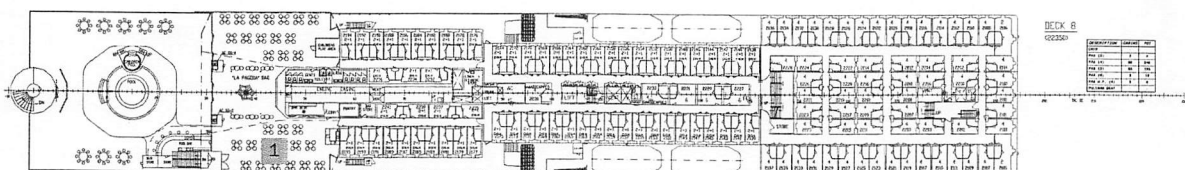
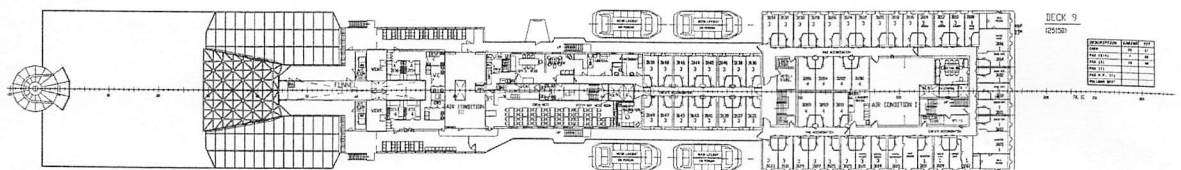
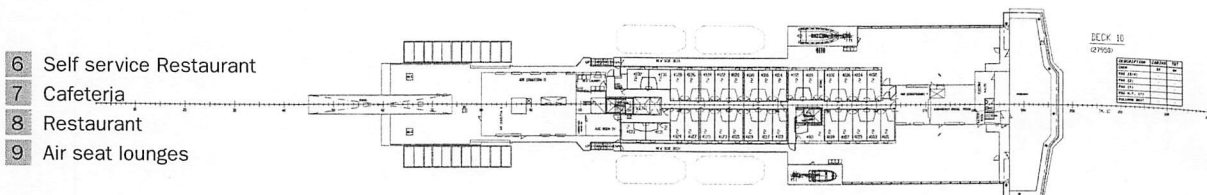

MEGA EXPRESS FOUR was originally built as SUPERFAST II (DESIGNS 95 page 189, editorial theme GUIDE 95) and has traded more recently in Australia as SPIRIT OF TASMANIA III, from where she was acquired by Corsica Ferries for conversion. The new owners managed to add more public space by extending the superstructure aft. On deck 7, a bar and aircraft seats were added along with a small shop, while the former seating lounge amidships on deck 7 was converted to a restaurant. The previous open, aft part of the upper trailer deck was turned into cabins accommodations and aircraft seating (deck 6), with more seating space and an entrance hall with reception area (deck 5). The former escalator

remains intact so that passengers arriving to the entrance reception may continue to the lounges on deck 7.

The new stern sees the incorporation of a circular staircase as on Corsica Ferries two first MEGA EXPRESS ferries, thereby making the new acquisition similar in style, as though launching a corporate design feature. On deck 8, a new outdoor space with a pool and pool bar has been created, where the "La Pagoda" bar is located as a glass-roofed indoor/outdoor attraction. Since her time in Australia, a new section of crew cabins was already added on deck 10.

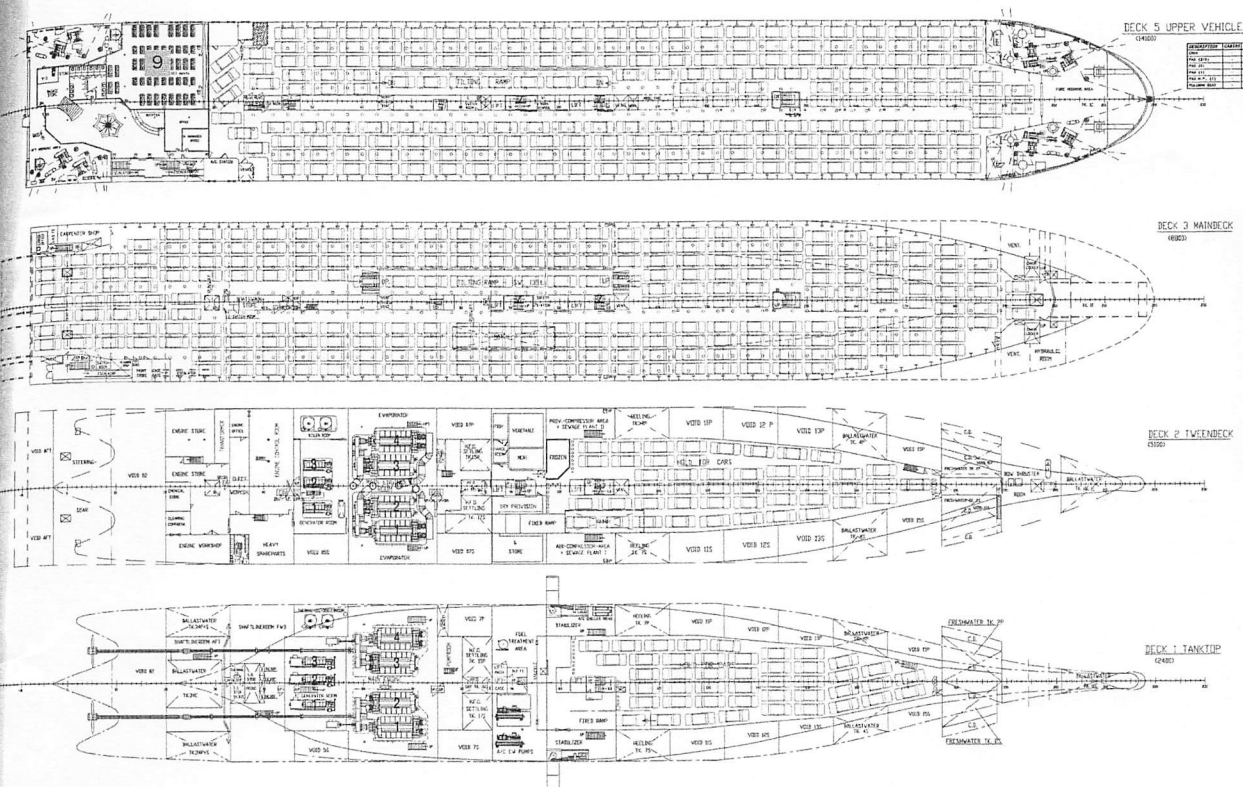

MEGA EXPRESS FOUR

## Steering communication

Let the professionals  
handle your PR. We are your  
partner for contacts  
and business  
in Europe.



EHRENBERG  
Kommunikation

LÜBECK · MALMÖ · KØBENHAVN · OSLO · BERLIN  
info@ehrenberg-kommunikation.com

www.ehrenberg-kommunikation.com

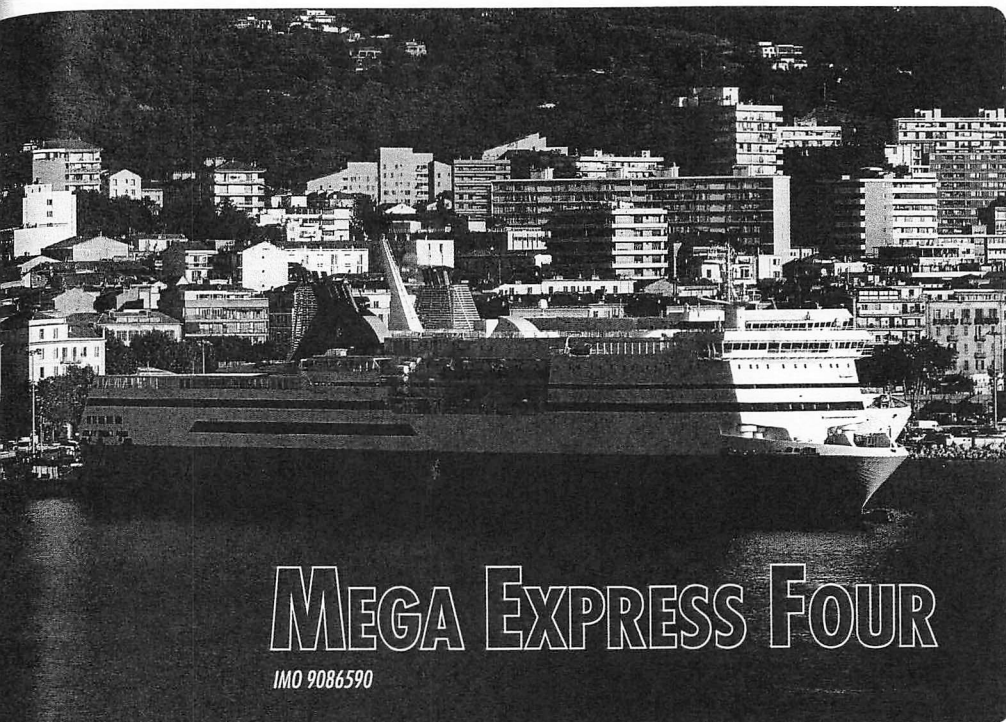

# MEGA EXPRESS FOUR

IMO 9086590



Converted by Mega-  
technica, Perama,  
Greece for Cor-  
sica Ferries, Bastia,  
France.  
Redelivered April  
30, 2007.  
In service between  
Toulon - Corsica/  
Sardinia.

MEGA EXPRESS FOUR

## CLASSIFICATION

## DIMENSIONS

Length o a	173.70 m
Length p p	158.00 m
Beam mid	24.00 m
Draft design	6.25 m
Draft scantling	6.10 m
Depth to maindeck	8.80 m

## TONNAGE

Gross	25,750
Net	11,000
Deadweight	4,855

## PASSENGERS

Total capacity	1,965
<b>Saloons</b>	
Pagoda Bar (deck 8)	132
Half service Restaurant (deck 7)	129
Pizzeria (deck 7)	68
Cafeteria (deck 7)	52
Bar lounge (deck 7)	167
Half service Restaurant (deck 7)	103
Cafeteria (deck 7)	83
Restaurant (deck 7)	225
Seat lounges (deck 5+6+7)	318
<b>Cabins</b>	
6-berth	18
Handicap	16
4-berth	248
2+2-berth	328
3-berth	291
2-berth	8
2 cabins	909

## CREW

Crew cabins	115
-------------	-----

## CAR/TRAILER DECKS

Deck	Free height	Cars	Lanem
Upper	4.6 m	210	600
Main	4.6 m	249	800
Tween		47	0
Tanktop		44	0
Capacity		550	0
or		97	1,400

## ACCESS

- **External access**
- Bow ramp, l x w ..... 14.0 x 5.0 m
- Stern ramp, PS, l x w ..... 7.0+2.0 x 8.0 m
- Stern ramp, SB, l x w ..... 7.0+2.0 x 8.0 m
- **Internal access**
- Tilting ramp main - upper deck
- l x w ..... 39.0 x 3.1 m
- Fixed ramp main deck - lower cardecks.

## MACHINERY

- **Main engines**
- Make ..... 4 Sulzer
- Type ..... 12VZA40S
- Effect, kW each ..... 7,920
- Rpm ..... 500
- **Auxiliary engines**
- Make ..... 3 MAN B&W
- Type ..... 6L28132H
- Effect, kW each ..... 1,260
- Shaft generators, kW ..... 2 x 1,120
- **Propellers**
- Make ..... 2 Kamewa
- Diameter ..... 4.9 m
- Rpm ..... 156
- Bow thrusters ..... 2 Kamewa
- Effect, kW each ..... 1,000
- **Other equipment**
- Fin stabilisers ..... Blohm + Voss

## SPEED/CONSUMPTION

Max speed	27.0 knots
Service speed	25.5 knots
Fuel consumption	144 t/24H

## TANK CAPACITIES

Heavy fuel oil	1,350 m³
Fresh water	300 m³
Ballast water	1,270 m³

## SELECTION OF SUPPLIERS

### Applicable for conversion only

- **Project**
- Naval architect ..... V.Ships Leisure
- Structural works for hotel dept ..... Ang Allestimenti Navali Giorgi
- **Accommodation**
- Carpet ..... Dansk Wilton
- Carpet ..... Rivestyle
- Catering area ..... Precetti
- Furnishing ..... Masullo Arredamenti
- Furnishing ..... F B Arredamenti
- Seats ..... Geven
- **Hardware/safety**
- Lifesaving appliances ..... Pedrotti/Viking
- Life-Saving ..... Life-Saving
- Radio, telephonic works ..... Telco Marine
- Sprinkler ..... De Martini
- Video surveillance ..... Mega Italia

