

# Millennium® Deck Plans

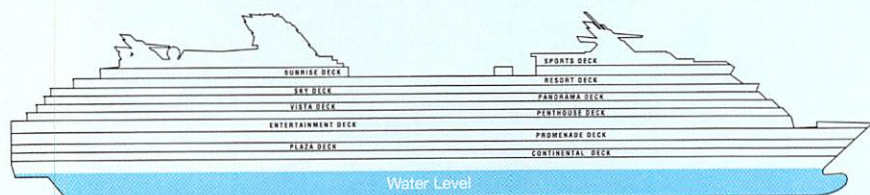

All staterooms have twin beds convertible to queen size, except as noted.

- Convertible sofa bed
- Sofa
- ▲ One upper berth
- ▲▲ Two upper berths
- ▲ Wheelchair-accessible stateroom featuring rolling showers
- ┃ Connecting staterooms

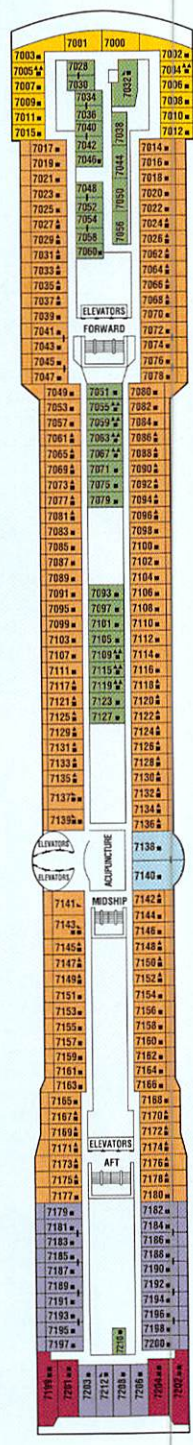
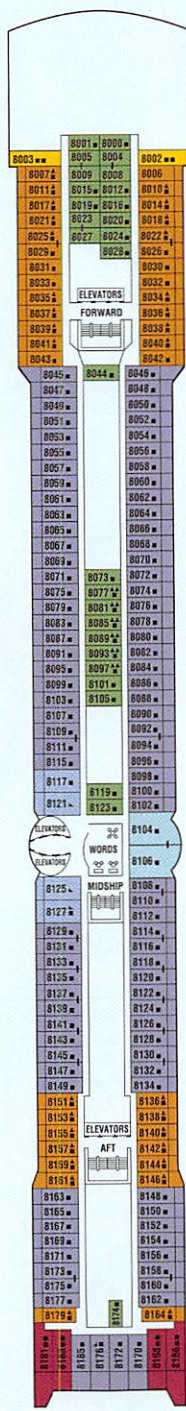
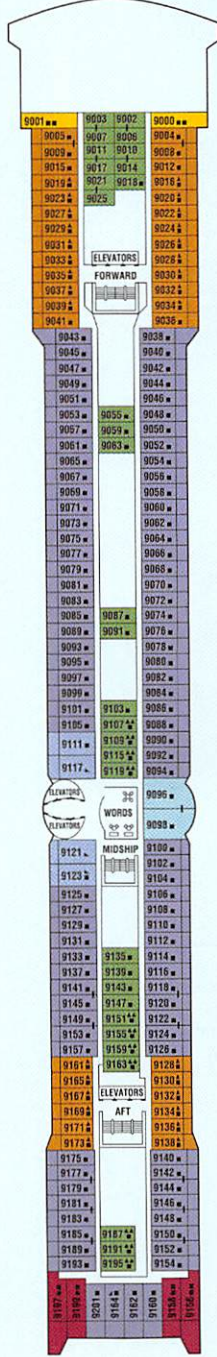
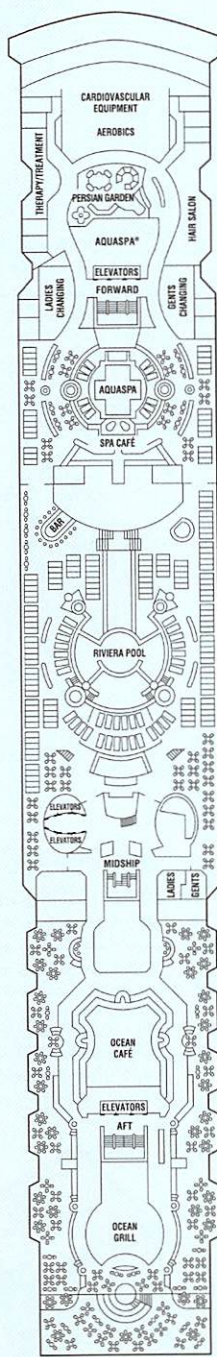
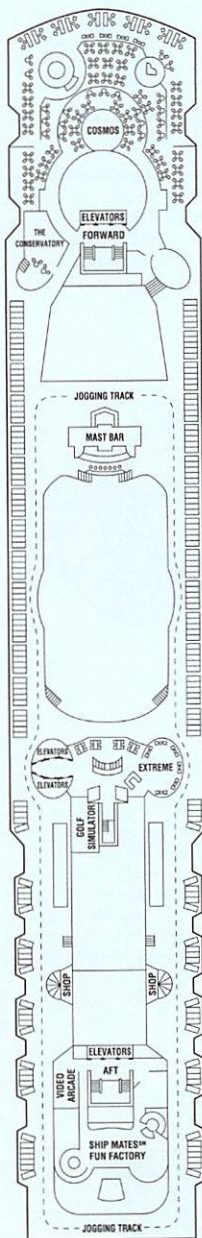
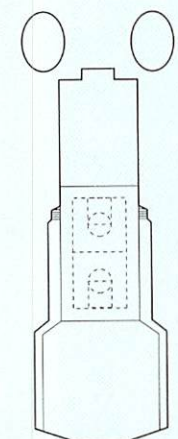
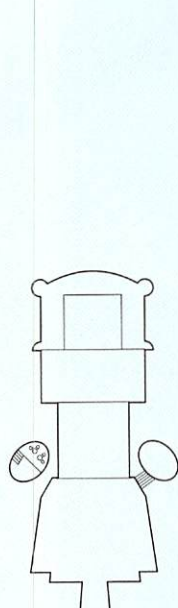

Sports

Sunrise

Resort

Sky

Panorama

Vista

CS SS CC FV  
2A 4 9

CS SS FV CC  
2A 4 9

CS FV CC  
2B 4 9



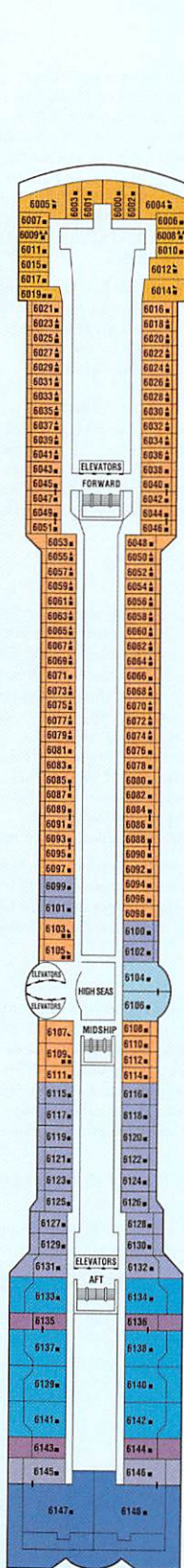

Penthouse

PS RS CS SS  
CC 2C 5

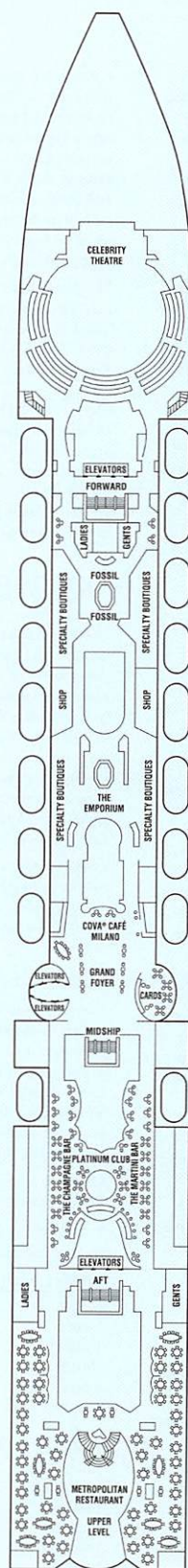

Entertainment

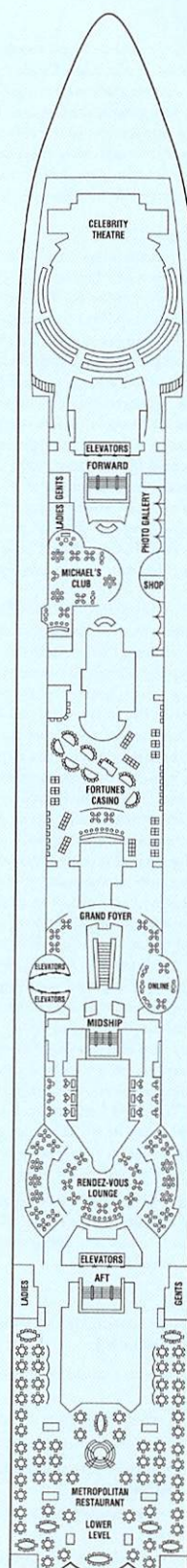

Promenade

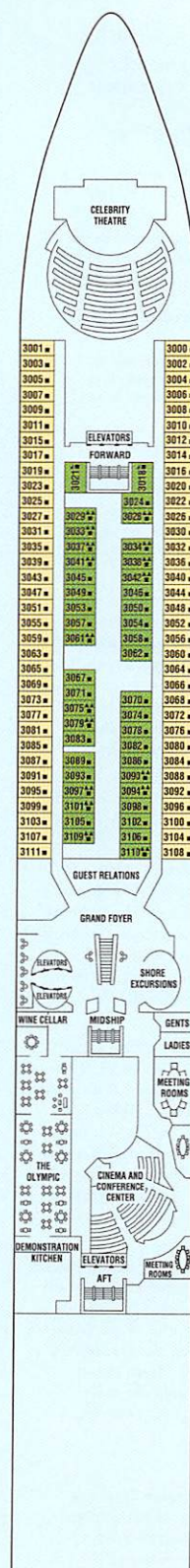

Plaza

6 10



Continental

7 8 11 12



# Millennium® Staterooms

For 360° virtual tours of Millennium decks and staterooms, visit us online at [celebrity.com](http://celebrity.com).

Luxurious amenities and attentive service come standard with all Celebrity staterooms. Eighty percent of all Millennium staterooms have ocean views and 74 percent offer verandas.

PS

## Penthouse Suite

Stateroom: 1,432 sq ft

Veranda: 1,098 sq ft

Features foyer; separate living and dining rooms; baby grand piano; butler's pantry; master bedroom with two lower beds convertible to queen size; exercise equipment; dressing room with vanity; marble master bath with whirlpool tub and separate shower; powder room with shower; motorized draperies, lights and security system; two interactive audio/visual entertainment systems with TVs, DVDs and VCRs; music center; outbound fax machine; Internet station; veranda with whirlpool, wet bar and lounge seating.

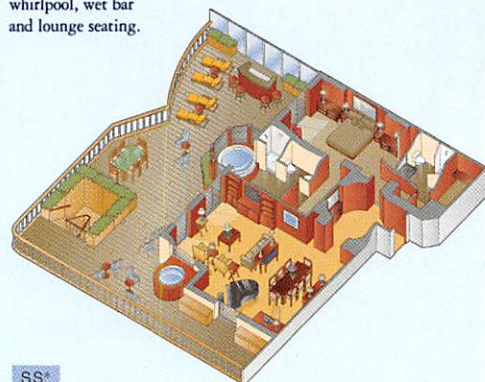

SS\*

## Sky Suite

Stateroom: 251 sq ft

Veranda: 57 sq ft

Features floor-to-ceiling sliding glass doors;\*\* sitting area, some with sofa bed and lounge chair; entertainment center with TV and VCR; two lower beds convertible to queen size.

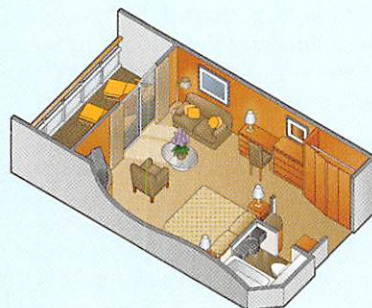

2A 2B 2C

## Deluxe Ocean View Stateroom with Veranda

Stateroom: 170 sq ft

Veranda: 38 sq ft

Features two convertible lower beds; floor-to-ceiling sliding glass doors; sitting area, some with sofa bed. 20" multifunction, interactive television; direct-dial telephone and voice mail; individual safe; hair dryer; thermostat-controlled air-conditioning; 100% cotton towels; complimentary use of bathrobes; complimentary 24-hour room service; private bar.<sup>1</sup>

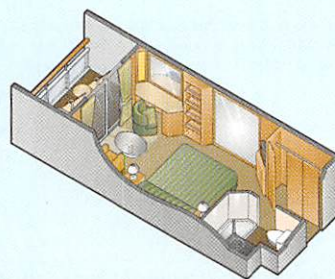

\* Some Sky Suites are wheelchair accessible.

\*\* Suites 6145 and 6146 feature standard balcony doors.

§ Private bar is not complimentary.

‡ Furniture configuration shown may vary in staterooms with third- and fourth-guest capacity.

All measurements are approximate. Drawings not to scale.

All staterooms have twin beds convertible to queen size, except as noted.



RS

### Royal Suite

Stateroom: 538 sq ft

Veranda: 195 sq ft

Features floor-to-ceiling sliding glass doors; separate living room with dining and sitting area; two entertainment centers with plasma-screen TVs and VCRs; Internet station; walk-in closet; bath, including tub with whirlpool jets and stall shower; veranda with whirlpool tub; some suites feature two lower beds convertible to queen size.



CS

### Celebrity Suite

Stateroom: 467 sq ft

Features two lower beds convertible to queen size; floor-to-ceiling panoramic windows; separate living room with dining and sitting area; two entertainment centers with plasma-screen TVs and VCRs; music center; Internet station; walk-in closet with vanity table; bath, including tub with whirlpool jets; glass-enclosed sitting area (connecting door to adjacent suite).

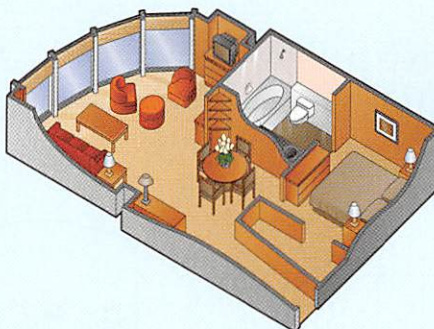

FV

### Family Ocean View

#### Stateroom with Veranda

Stateroom: 271 sq ft

Veranda: 242 sq ft

Features two convertible lower beds; floor-to-ceiling sliding glass doors; privacy partition; sitting area, some with two sofa beds. This room is intended for families traveling together.

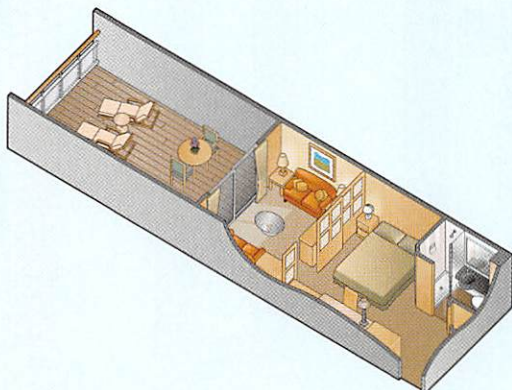

CC

### Celebrity Concierge Class®

Stateroom: 191 sq ft

Veranda: 41 sq ft

Features floor-to-ceiling glass doors; two convertible lower beds; large sitting area, some with sofa bed. Some of the benefits include enhanced service, priority embarkation/disembarkation, fresh fruit and flowers, welcome champagne and a Hansgrohe® massaging showerhead.

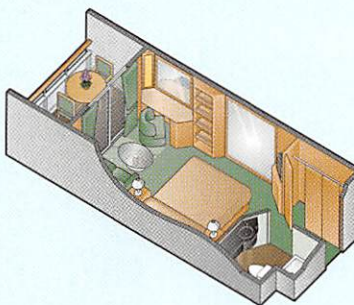

4

5

6

7

8

### Ocean View Stateroom

Stateroom: 170 sq ft

Features two convertible lower beds; window; sitting area, some with sofa bed; 20" multifunction, interactive television; direct-dial telephone and voice mail; individual safe; hair dryer; thermostat-controlled air-conditioning; 100% cotton towels; complimentary use of bathrobes; complimentary 24-hour room service; private bar.<sup>1</sup>

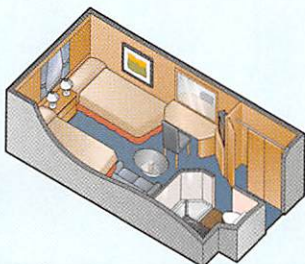

9

10

11

12

### Inside Stateroom

Stateroom: 170 sq ft

Features two convertible lower beds; sitting area, some with sofa bed (stateroom layout same as Cat. 4-8, but without window); 20" multifunction, interactive television; direct-dial telephone and voice mail; individual safe; hair dryer; thermostat-controlled air-conditioning; 100% cotton towels; complimentary use of bathrobes; complimentary 24-hour room service; private bar.<sup>1</sup>

