

DECK PLANS

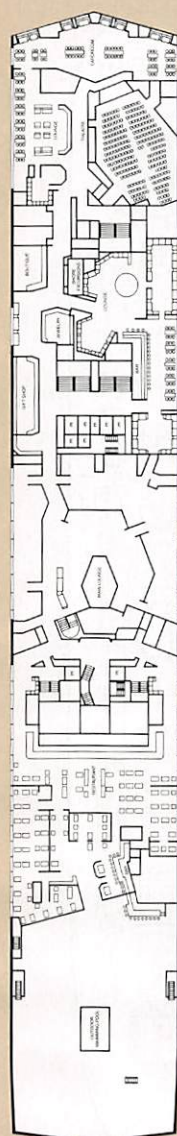

PROMENADE DECK



MAIN DECK
ROOMS 300-370

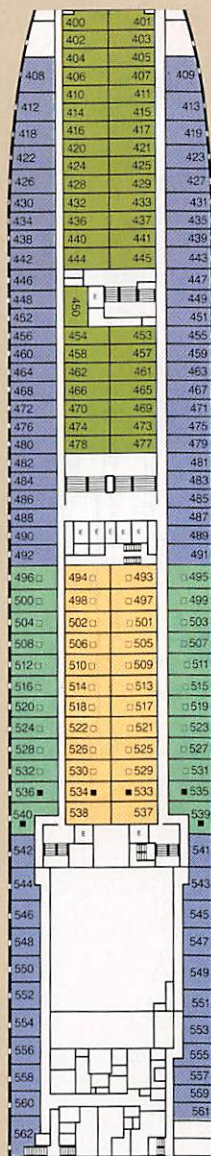

A DECK
ROOMS 400-499 & 500-561



B DECK
ROOMS 600-699 & 700-714

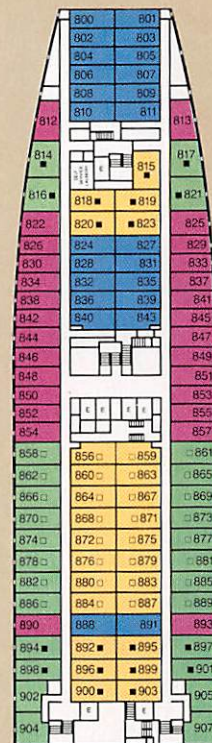

C DECK
ROOMS 800-899 & 900-907



Ships' Registry: Netherlands Antilles.

SUPPLEMENTARY FARES

CATEGORY	NORTH-BOUND	SOUTH-BOUND	ROUND TRIP
A Staterooms Deluxe	\$495	\$660	\$1155
B Deluxe Outside Double/Twin	275	365	640
C Deluxe Outside Double/Twin	250	330	580
D Large Outside Double/Twin	205	275	480
E Outside Twin	165	215	380
F Outside Twin	130	170	300
G Large Inside Double/Twin	85	115	200
H Inside Twin	45	55	100
I Inside Twin	BASE	BASE	BASE

- BATH
- ▲ KING SIZE BED
- QUEEN SIZE BED
- TRIPLE (KING SIZE BED AND SOFA BED)
- QUAD (TWO LOWERS, TWO PULLMANS)
- + CONNECTING ROOMS
- ◆ ON NOORDAM ONLY; AVAILABLE WITH EITHER TWIN BEDS OR ONE QUEEN SIZE BED.

SS ROTTERDAM DECK PLANS



NAVIGATING
BRIDGE DECK

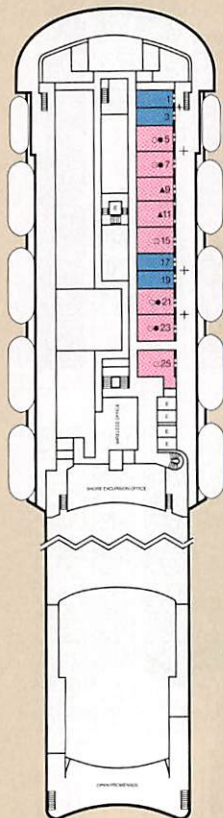

SUN DECK
ROOMS 1-25

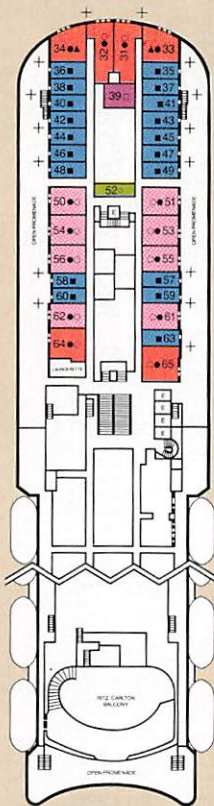

BOAT DECK
ROOMS 31-65

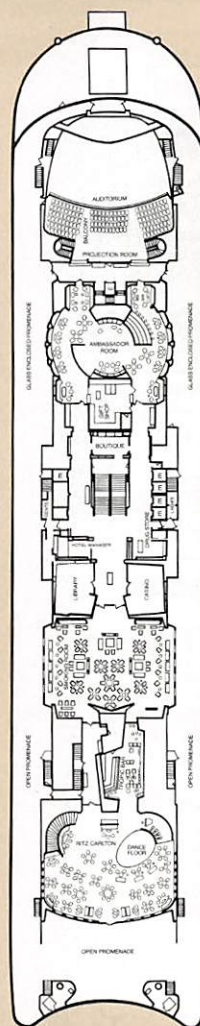

UPPER PROMENADE DECK

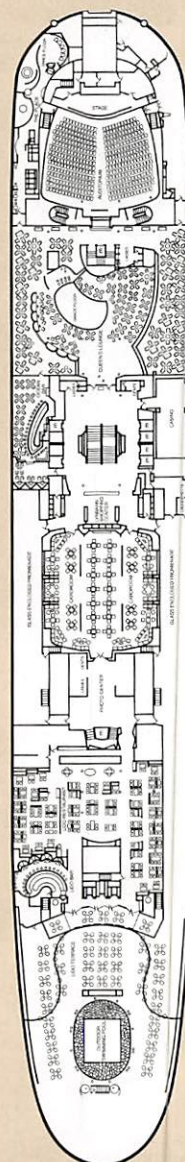

PROMENADE DECK

LOWER PROMENADE DECK
MAIN DECK
A DECK
B DECK
C DECK
D DECK

BRIDGE DECK
SUN DECK
BOAT DECK
UPPER PROMENADE DECK
PROMENADE DECK

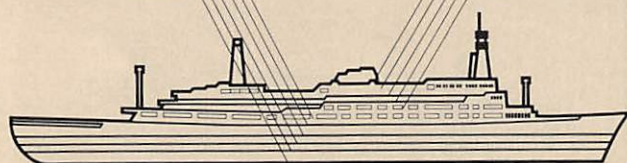

Ship's Registry: Netherlands Antilles.

STATEROOMS

A
CABINS
DELUXE

Grand, gracious, elegant accommodations. Our largest staterooms have a comfortable bedroom with spacious sitting room area, separate wardrobe room, large bathroom with double vanity, shower and bath. All the amenities, even a refrigerator.

B
DELUXE OUTSIDE
TWIN

Luxuriously large and extremely desirable. These spacious staterooms give you twin beds, bath and shower. Plus the comfort and pleasure of a sitting area with sofa and easy chairs.

C **D**
LARGE OUTSIDE
TWIN

These delightful two-porthole staterooms are furnished with twin beds, shower, or bath and shower. Some rooms in category D have less sitting area and may have one twin bed and one convertible bed.

E **F**
LARGE INSIDE
TWIN

Roomy staterooms with twin beds, shower, or bath and shower. Some rooms in category F have less sitting area.

G **I**
ECONOMY OUTSIDE UPPER/LOWER
OUTSIDE SINGLE

Charming staterooms with lower bed and upper berth, and shower, or bath and shower.

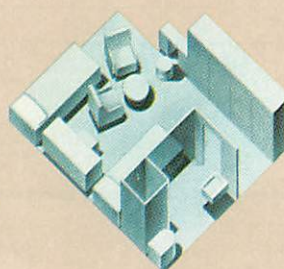
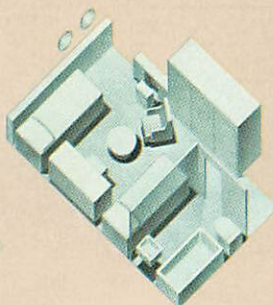
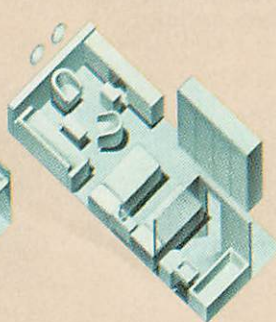
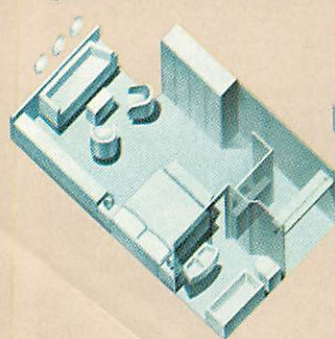

Descriptions and diagrams are representative of the staterooms in the categories indicated. Staterooms within each category may vary in layout and decor.

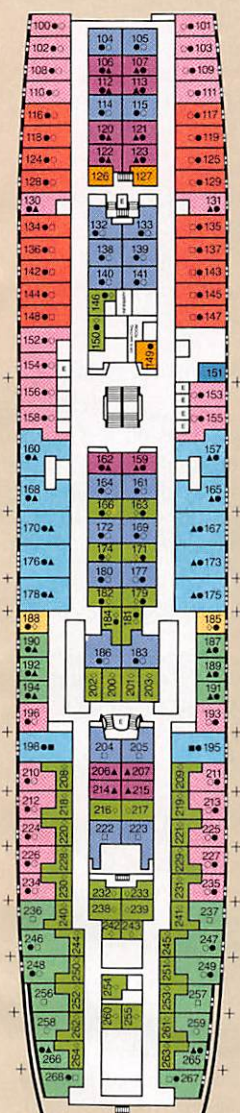

LOWER PROMENADE DECK
ROOMS 100-198 & 200-269

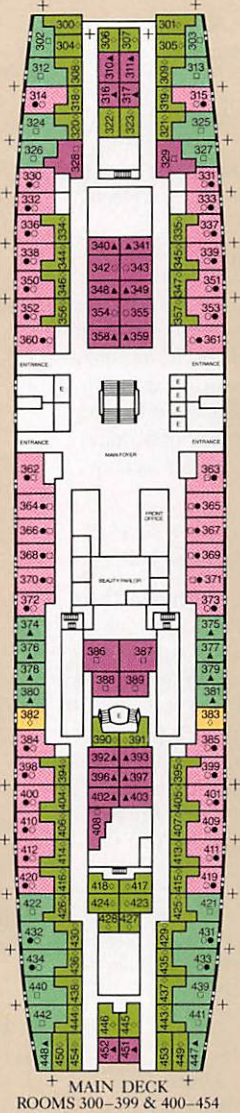

MAIN DECK
ROOMS 300-399 & 400-454



A DECK
ROOMS 488-499, 500-599
& 600-640

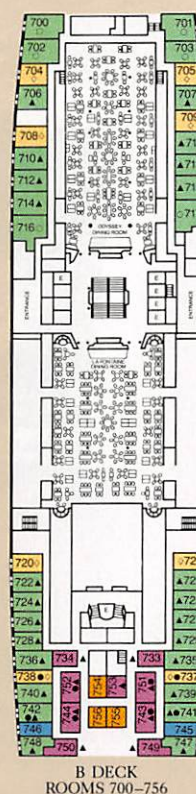

B DECK
ROOMS 700-756



D DECK

SUPPLEMENTARY FARES

■ H ■ J
 ECONOMY INSIDE UPPER/LOWER
 INSIDE SINGLE

Cozy rooms with lower bed and upper berth. All rooms have private shower.

CATEGORY

	NORTH-BOUND	SOUTH-BOUND	ROUND TRIP
■ A Cabins Deluxe	\$540	\$715	\$1255
■ B Deluxe Outside Twin	300	400	700
■ C Large Outside Twin	225	295	520
■ D Outside Twin	195	255	450
■ E Large Inside Twin	150	200	350
■ F Inside Twin	105	145	250
■ G Economy Outside Upper/Lower	65	85	150
■ H Economy Inside Upper/Lower	BASE	BASE	BASE
■ I Outside Single	300	405	705
■ J Inside Single	170	230	400

- BATH WITH OVERHEAD SHOWER
- SOFA BED
- ◇ DOUBLE (ONE LOWER, ONE PULLMAN)
- ▲ DOUBLE (TWO LOWERS)
- TRIPLE (TWO LOWERS, ONE PULLMAN)
- QUAD (TWO LOWERS, TWO PULLMANS)
- + CONNECTING ROOMS



OPTIONAL TOURS

ADDITIONAL ALASKAN EXPERIENCES.

For 37 years we have been helping people enjoy Alaska. Our experience also tells us that you may want to add an optional excursion to your existing tour. In 1984, we offer the following optional tours. Most are available for purchase en route. However, to ensure availability, advance reservations are recommended.

All tour prices include transportation and sightseeing as described, and shared hotel accommodations on overnight tours. Not included are meals, tips, and items of a personal nature. *Rates are per person.* Single hotel rooms, at a supplementary charge, may be requested (but are not guaranteed) on the Arctic Adventure Tour and the Columbia Glacier Tour. If not available on arrival, an appropriate refund will be made for the difference in room rates. Single rooms are not available on the Pribilof Island Tour.

FROM ANCHORAGE:

The following optional overnight tours generally require one additional night Anchorage accommodations when added to an Alaska tour itinerary.

ARCTIC ADVENTURE TOUR TO NOME AND KOTZEBUE (OVERNIGHT NOME)

Daily: May 28-June 15
\$401.00 + \$17.04 tax
Daily: June 16-Sept. 17
\$454.00 + \$21.26 tax
Plus Anchorage airport transfers:
\$14.50

Note: Some departures may operate in reverse. All sightseeing and events are included in either itinerary.

DAY 1:

Jet across the Arctic Circle to Kotzebue, where your tour includes the Living Museum of the Arctic, blanket toss demonstration, sod house, and Reindeer corral. Then fly to Nome for an overnight.



DAY 2:

In Nome, learn the story of the King Island Eskimos. See a gold mine and pan for gold. Visit the Arctic Trading Post museum. See a real dogsled and an Eskimo skin boat. Shop for Eskimo handicrafts before returning to Anchorage.

PRIBILOF BIRD AND SEAL ISLAND TOUR

3 Days/2 Nights
Tuesday and Thursday departures:
June 5-Aug. 28
\$654.00 + \$28.16 tax
Plus Anchorage airport transfers:
\$14.50

4 Days/3 Nights
Saturday departures:
June 9-Aug. 25
\$714.00 + \$28.16 tax

Plus Anchorage airport transfers:
\$14.50

DAY 1:

Fly to the Pribilof Islands in the Bering Sea for a unique view of one of the greatest displays of wildlife on earth. Transfer to your hotel on St. Paul Island. Visit the Aleut community and see the old Russian Orthodox Church.

DAY 2 AND ADDITIONAL DAYS:

Thrill to the sight of more than a million fur seals in this international wildlife sanctuary. Visit the sea bird rookeries, where more than 180 bird species have been sighted. Tour the tundra with its wild flowers, Arctic fox and reindeer. Return to Anchorage via Reeve Aleutian Airways.

COLUMBIA GLACIER CRUISE/TOUR

2 Day Tour

Daily: May 29-Sept. 18
\$225.00

Note: This tour operates as outlined below or in the reverse direction.

DAY 1. VALDEZ:

A Westours motorcoach takes you east through the rich farmlands of the Matanuska Valley, then south through beautiful Keystone Canyon to the port city of Valdez and your overnight accommodations.

DAY 2. COLUMBIA GLACIER/WHITTIER/ANCHORAGE:

Board the Glacier Queen II to sail to the face of Columbia Glacier, Alaska's most active tidewater glacier. Watch huge slabs of ice fall into the sea, filling the bay with icebergs. Then sail scenic Prince William Sound to the port of Whittier. Board a Westours motorcoach for the trip along Turnagain Arm to Anchorage.

FROM FAIRBANKS:

TOP OF THE WORLD TOUR TO PT. BARROW

1 Day Tour

Daily: June 1-15
\$299.00 + \$16.13 tax
Daily: June 16-Aug. 30
\$349.00 + \$20.15 tax

Jet across the Arctic Circle to Pt. Barrow, the northernmost point of land on the continent. Visit the Eskimo community and learn of their subsistence way of life and cultural heritage. Witness the Eskimo Blanket Toss and a ceremonial dance program. Learn about native whale hunts. Shop for handmade crafts before an afternoon return flight.

FAIRBANKS STERNWHEELER "DISCOVERY" CRUISE

4 Hour Cruise
Daily: \$30.00
Transfers Included

Experience the thrill of riding the last of the Alaskan sternwheeler riverboats. Captain Jim Binkley takes you on a delightful cruise along the Chena and Tanana "Ice Pool River."

FROM SEATTLE OR VANCOUVER:

SPECIAL SEATTLE/VICTORIA/VANCOUVER EXCURSION

Seattle departures
Monday, Wednesday and Saturday:
June 6-Sept. 15
(except Monday, Sept. 10)

Vancouver departures
Tuesday, Thursday and Saturday:
June 16-Sept. 25
(except Thursday, Sept. 20)

Single: \$415.00 + \$20.50 tax
Double/Twin: \$295.00 + \$7.50 tax
Note: Tour operates from Seattle as outlined below or from Vancouver in the reverse order and are available for each Alaska cruise departure.

DAY 1. ARRIVE SEATTLE AND OVERNIGHT:

Arrive in Seattle and transfer by Airporter to your downtown hotel for overnight in the "Emerald City."

DAY 2. VICTORIA AND BUTCHART GARDENS:

Travel by motorcoach and ferry to Victoria. Visit world-famous Butchart Gardens before arriving at your hotel.

DAY 3. VICTORIA/VANCOUVER:

Explore charming British-feeling Victoria. Midday departure by motorcoach and ferry to Vancouver where you overnight.

DAY 4. VANCOUVER SIGHTSEEING:

Explore the largest city on the Canadian West Coast. An afternoon tour shows you the special sights of this cosmopolitan city and takes you to the pier for your Alaska cruise departure.

SPECIAL MOTORCOACH SERVICE BETWEEN SEATTLE AND VANCOUVER

\$25.00 (one way)

Special motorcoach service is available between Seattle and Vancouver in each direction in connection with each arrival and sailing date of The Nieuw Amsterdam, The Noordam and the ss Rotterdam. Advance reservations are required and should be made with tour reservations.