

# ATROSS

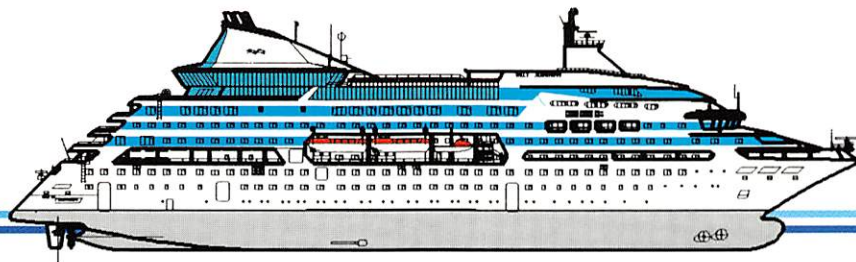

LEISURE  
FACILITIES



RESTAURANTS



CREW AREA



CONFERENCE  
FACILITIES



SHOPS



PASSENGER  
CABINS

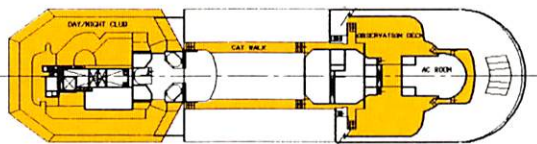

10 DECK

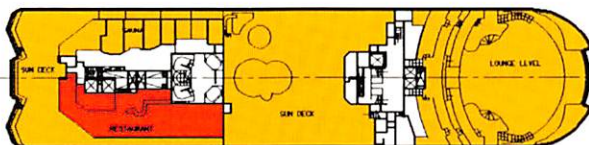

9 DECK

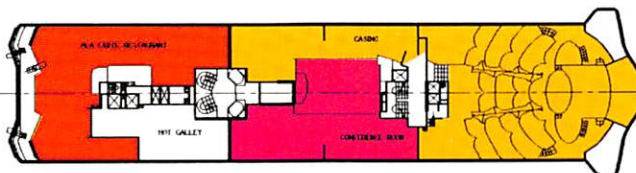

8 DECK

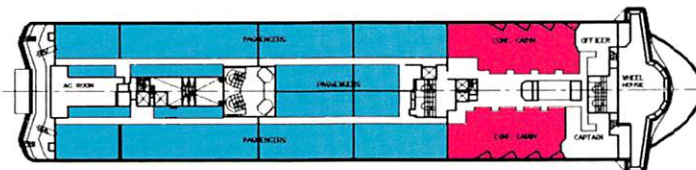

7 DECK

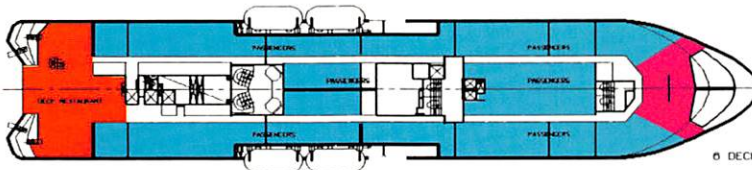

6 DECK

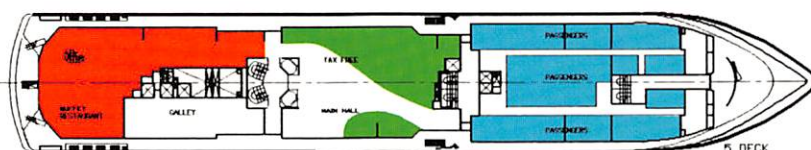

5 DECK

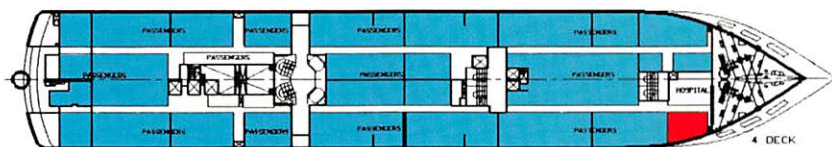

4 DECK

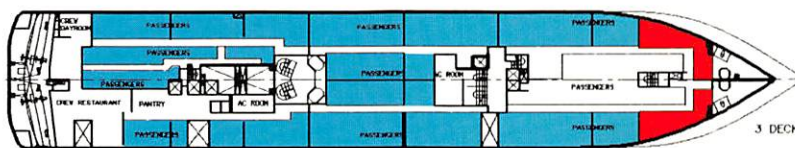

3 DECK

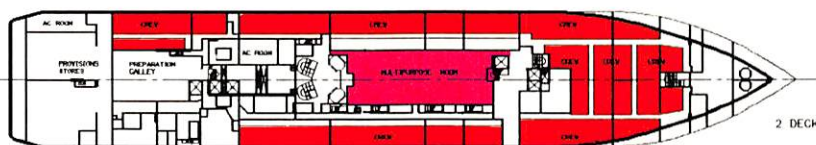

2 DECK



# THE EUROCRUISER

Cruises are becoming increasingly popular among tourists the world over. Not even the recession seems to have affected the numbers of travellers. However, not everyone has the time or even the desire to embark on cruises lasting a week or more.

Specially arranged short cruises on the Baltic Sea, providing either one or two days of luxurious relaxation, have proved highly popular among those wanting to "get away". A short cruise doesn't demand weeks of planning. In fact, it offers a chance to enjoy a refreshing break at any time.

Sally Line specializes in arranging cruises within Europe. The company's new flagship, the Sally Albatross, has been designed and built specially for this purpose. Passengers on the Sally Albatross can enjoy everything that other luxury cruise liners offer without spending several days at sea. The show lounge, fitted with all the latest equipment, offers top entertainment, while the casino is just the place to try your luck. One of the secrets behind the success of the Sally Albatross is that there's so much to do. Making passengers want to come back again and again.

